

**STATE OF OKLAHOMA  
TEXAS COUNTY  
PUBLIC SERVICE/PIPELINE CROSSING  
LINE INSTALLATION**  
*(Revised February 2026)*

D1

We, the undersigned, hereby petition the Texas County Board of County Commissioners to grant a permit for a public service, pipeline crossing, or line installation as described below and in accordance with the provisions as listed.

**PUBLIC SERVICE/PIPELINE OWNER**

Name Tony Whitfield  
Contact PTCI  
Address 607 S Main St  
City Guymon State OK Zip 73942  
Phone 580-468-2439

**CONSTRUCTION COMPANY**

Name \_\_\_\_\_  
Contact \_\_\_\_\_  
Address \_\_\_\_\_  
City \_\_\_\_\_ State \_\_\_\_\_ Zip \_\_\_\_\_  
Phone \_\_\_\_\_

**TYPE OF INSTALLATION**

Electric  Gas  Oil  Water  Telephone  Sewer  Other  \_\_\_\_\_

The installation will be made in the following manner:

Boring  Pushing  Overhead Crossing  Other  Plowing

A permit to erect, construct and maintain a communication line along, upon and across the hereinafter said county highway or road for the purpose of transporting, selling, and using communications. A plat shall be attached clearly illustrating work to be performed and further described as follows:

From the intersection of RD K and Mile 44, on the south RoW, going east 1/2 mile to HWY 54.

**LOCATION:**

Start point in the SE Qtr. of the SE Qtr. of Section 32 Township 5 Range 17  
Crossing or parallel to county road number MILE 44 RD, RD K  
Ending point in the SE Qtr. of the SW Qtr. of Section 33 Township 5 Range 17

**PIPELINES**

Size \_\_\_\_\_  
Alloy/Material \_\_\_\_\_  
Contents \_\_\_\_\_  
Mfg. Test Pressure \_\_\_\_\_  
Working Pressure \_\_\_\_\_  
Max. Operating Pressure \_\_\_\_\_

**ELECTRIC**

Voltage \_\_\_\_\_  
Conductor Size \_\_\_\_\_  
Type of Structure \_\_\_\_\_  
Ruling Span \_\_\_\_\_

**COMMUNICATIONS**

Wires/Pairs/Strands 96 FIBER  
Gauge \_\_\_\_\_  
Cable Type FIBER OPTIC

**CASING**

Size 1.5SDR  
Alloy/Material \_\_\_\_\_  
Wall Thickness \_\_\_\_\_

If granted, this permit is subject to the following conditions, requirements, and covenants, to wit:

- 1 Applications for road crossing must be submitted to the County Clerk no later than 5 days before a meeting of the Board of County Commissioners with a check for the amount of permit made payable to the TEXAS County Commissioners. The petitioner/contractor shall contact The County Commissioners Office at the completion of crossing for an onsite inspection.  
**To: Texas County Commissioners**  
**PO Box 197 319 N Main. St.**  
**Guymon, OK. 73942**
- 2 The applicant must agree to hold Texas County harmless for any damage or injury to persons or property caused by or resulting from the construction, maintenance, operation, or repair of the facilities on, under, or over the County right-of-way. The petitioner/contractor will be responsible for any damage resulting from deviation of the plat.
- 3 All crossings shall be bored on all roads.
- 4 The petitioner/contractor shall furnish all flagmen, lights, barricades, and warning signs meeting all laws and regulations, including those in the “Manual or Uniform Traffic Control Devices” appropriate for the construction project. The petitioner/contractor agrees to keep the road open to traffic unless approved by the Board of County Commissioners. At the conclusion of such work, the right-of-way must be cleaned up and left in a presentable condition.
- 5 In some cases, the petitioner/contractor shall post a performance bond in an amount to be determined by the Board of County Commissioners. Necessity for such bond will be determined by the Board of County Commissioners and the bond will be held in the County Treasurers office until the right-of-way is in a presentable condition.
- 6 When notified to do so by the Board of County Commissioners the petitioner/contractor agrees at their expense to make all changes in the facility on County right-of-way.
- 7 Aerial Facilities-Clearance above the traffic lanes of the road at all aerial pole line crossings shall comply with applicable safety codes and will not be less than 20 feet. All poles, posts, studs, fixtures, down guys, wires, and other appurtenances must be kept in good repair at all times and free from weeds and brush within a 5 foot area of the installation. These facilities, when paralleling the roadway, shall be single pole line construction and located within 3 feet of the fence line, if a fence exists. If no fence exists the right-of-way line shall be located by an Oklahoma Registered Surveyor at the petitioner’s expense and a copy provided to the Board prior to construction. All crossings shall be as nearly perpendicular as possible. Facility shall not interfere with the natural flow line of waterways or ditch.
- 8 Underground Facilities- All shall be a minimum of 5 feet below the elevation of the centerline of the road, but not less than 4 feet below the bottom of the ditch. Crossings shall be encased from right-of-way line to right-of-way line and be vented off the right-of-way lines. Concrete caps 4’ wide and 6” deep may be required from edge of road to fence line. Identification markers shall be installed at each right-of-way line directly above the facility. The markers must identify the owner’s name, address, telephone number, size of facility, and emergency contact number in compliance with the APWA Uniform Color Code for marking. All underground electric cable crossings must be placed in a conduit



Permit Approval

The undersigned Board of County Commissioners do hereby grant the crossing described in the supplication herein above set forth; provided that, the same shall be subject to the terms and conditions of the application incorporated herein by this reference.

Approved/Disapproved on this 22nd Day of June, 20 26  
County Dist # 1

Board of County Commissioners

David Stewart  
Chairman



Levi Balfanz  
Vice-Chairman

Oliver Hodge  
Member

Attest: Wendy Johnson  
County Clerk/Deputy

Dated: June 22, 20 26

CERTIFICATE OF COMPLIANCE  
(Utility Permit # 164-25-26)

PLEASE NOTE: an officer must sign this Certificate of Compliance of your firm or a Project Director.

I, the undersigned \_\_\_\_\_, do hereby certify that I am \_\_\_\_\_ (title), a person deemed qualified by the Permit Holder to inspect said installation, and that I have personally inspected a utility pipeline facility and all drawings, plans and specifications therefore; installed by \_\_\_\_\_ PTCI \_\_\_\_\_ (permit holder) at (give legal description):

Start: SE4-SE4-32-5N-17ECM

Finish: SE4-SW4-33-5N-17ECM

I further certify that I have read the provisions of the Facility and Pipeline Utility Permit Submitted by the above Permit Holder to the Board of County Commissioners for installation of a line at the above location. I further certify that, in my professional opinion, the facility line as installed, and the drawings, plans and specifications therefore comply in all respects with the requirements of said Permit.

\_\_\_\_\_  
Signature

\_\_\_\_\_  
Title/Firm/Owner

\_\_\_\_\_  
Address

\_\_\_\_\_  
Telephone

\_\_\_\_\_  
Completion Date/Date of Inspection

**Submit this form to**

**the Board of County Commissioners at the Texas County Courthouse  
PO Box 197 or 319 N Main Street Suite 202, Guymon, Oklahoma 73942 within 24 Hours of completion of  
facility or pipeline installation.**

RESOLUTION FOR APPROVAL OF UTILITY PERMITS  
(RESOLUTION # 164-25-26)

Dist. 1

WHEREAS, the Statutes of the State of Oklahoma [OKLA. STAT. Tit. 18, § 437.2 and 438.4 (1991) and OKLA STAT. Tit. 69, § 1401 (1991)] provide that rural electric cooperatives, telephone cooperative corporations and public utilities shall have the right-of-way and all easements pertaining thereto for the purpose of erecting poles and posts, attaching equipment wires and fixtures thereto and laying lines, pipes and conduits under the surface thereof.

WHEREAS, PTCI has requested this Board's approval of placement of utility lines (poles, pipelines, telecommunication lines or power lines) within the County right-of-way at the following location, to-wit:

From the intersection of RD K and Mile 44, on the south RoW, going east 1/2 mile to HWY 54.

Start: SE4-SE4-32-5N-17ECM

Finish: SE4-SW4-33-5N-17ECM

WHEREAS, petitioner must meet all requirements of the permit.

THEREFORE, BE IT RESOLVED, the Board of County Commissioners of Texas County, Oklahoma, does hereby consent to the placement of a distribution line according to the requirements as set forth in the completed Permit Application attached. With the following special instruction to be included:

All requirements of the permit must be met, and it shall be bored.

PERMIT # 164-25-26 Granted this 22nd day of June 20 26.

BOARD OF COUNTY COMMISSIONERS

Donald Wood  
Chairman

Levi Bussard  
Member

Oliver Sledge  
Member



ATTEST:

Wendy Johnson  
Texas County Clerk

# MAP 18

# R17E

# JOINS MAP 8

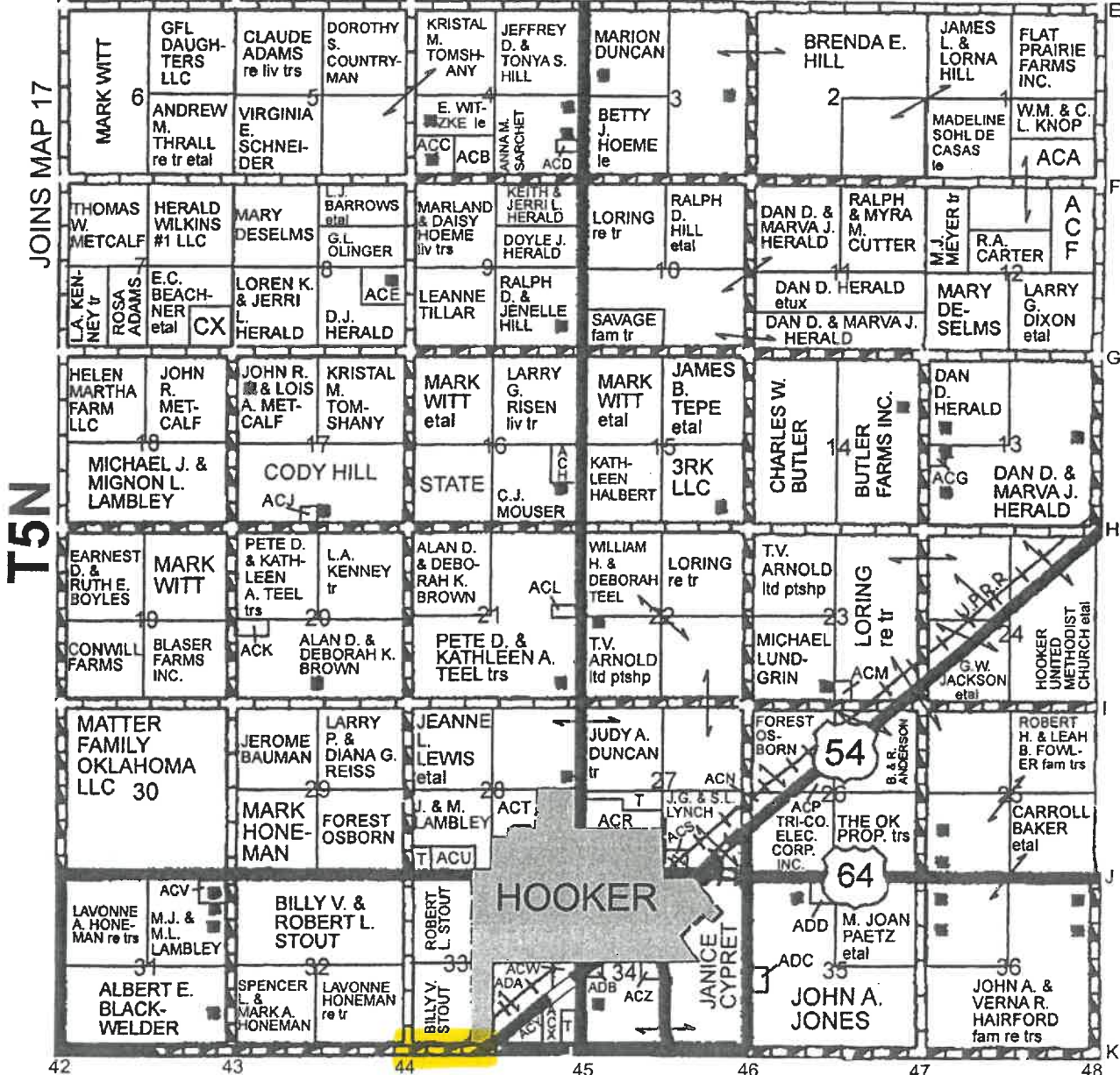

# JOINS MAP 28