

RESOLUTION FOR APPROVAL OF UTILITY PERMITS
(RESOLUTION # 28-16-17)

Dist. 2

WHEREAS, the Statutes of the State of Oklahoma [OKLA. STAT. Tit. 18, § 437.2 and 438.4 (1991) and OKLA STAT. Tit. 69, § 1401 (1991)] provide that rural electric cooperatives, telephone cooperative corporations and public utilities shall have the right-of-way and all easements pertaining thereto for the purpose of erecting poles and posts, attaching equipment wires and fixtures thereto and laying lines, pipes and conduits under the surface thereof.

WHEREAS, GridLiance dba South Central MCN has requested this Board's approval of placement of utility lines (poles, pipelines, telecommunication lines or power lines) within the County right-of-way at the following location, to-wit:

See attached project description and associated maps.

NE/4 NE/4 Sec 6-T3N-R15Ecm to NW/4 NW/4 Sec 5-T3N-R15Ecm

WHEREAS, petitioner must meet all requirements of the permit.

THEREFORE, BE IT RESOLVED, the Board of County Commissioners of Texas County, Oklahoma, does hereby consent to the placement of a distribution line according to the requirements as set forth in the completed Permit Application attached. With the following special instruction to be included:

All requirements of the permit must be met and it shall be done.

PERMIT # 28-16-17 Granted this 16th day of January 20 17

BOARD OF COUNTY COMMISSIONERS

[Signature]
Chairman

[Signature]
Member

[Signature]
Member

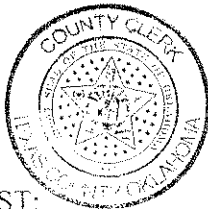

ATTEST:

Wendy Johnson
Texas County Clerk

STATE OF OKLAHOMA
TEXAS COUNTY
PUBLIC SERVICE/PIPELINE CROSSING
LINE INSTALLATION
(Revised May 14, 2015)

We, the undersigned, hereby petition the Texas County Board of County Commissioners to grant a permit for a public service, pipeline crossing, or line installation as described below and in accordance with the provisions as listed.

PUBLIC SERVICE/PIPELINE OWNER

CONSTRUCTION COMPANY

Name GridLiance dba South Central MCN

Name TBD after bidding is complete.

Contact Noman Williams

Contact _____

Address 11500 NW Ambassador Drive, Suite 310

Address _____

City Kansas City State MO Zip 64153

City _____ State _____ Zip _____

Phone 563.940.1419

Phone _____

TYPE OF INSTALLATION

Electric Gas Oil Water Telephone Sewer Other _____

The installation will be made in the following manner:

Boring Pushing Overhead Crossing Other _____ *→ For Eva 69 kV line*

A permit to erect, construct and maintain a 69 kV electric power transmission line along, upon and across the hereinafter said county highway or road for the purpose of transporting, selling, and using electric power. A plat shall be attached clearly illustrating work to be performed and further described as follows:

LOCATION:

Start point in the NE Qtr. of the NE Qtr. of Section 6 Township 3N Range 15E

Crossing or parallel to county road number NO860 Road

Ending point in the NW Qtr. of the NW Qtr. of Section 5 Township 3N Range 15E

PIPELINES

Size N/A

Alloy/Material N/A

Contents N/A

Mfg. Test Pressure N/A

Working Pressure N/A

Max. Operating Pressure N/A

ELECTRIC

Voltage 69 kV

Conductor Size (3) 954 ACSS Cardinal

Type of Structure H-frame, wood

Ruling Span 163 feet

COMMUNICATIONS

Wires/Pairs/Strands N/A

Gauge N/A

Cable Type N/A

CASING

Size N/A

Alloy/Material N/A

Wall Thickness N/A

If granted, this permit is subject to the following conditions, requirements, and covenants, to wit:

- 1 Applications for road crossing must be submitted to the County Clerk no later than 5 days before a meeting of the Board of County Commissioners with a check for the amount of permit made payable to the TEXAS County Commissioners. The petitioner/contractor shall contact The County Commissioners Office at the completion of crossing for an onsite inspection.
To: Texas County Commissioners
PO Box 197 319 N Main. St.
Guymon, OK. 73942
- 2 The applicant must agree to hold Texas County harmless for any damage or injury to persons or property caused by or resulting from the construction, maintenance, operation, or repair of the facilities on, under, or over the County right-of-way. The petitioner/contractor will be responsible for any damage resulting from deviation of the plat.
- 3 All crossings shall be bored on blacktop/asphalt roads. Cutting may be permitted on caliche/dirt roads, ditches, or other surfaces with approval from the Board of County Commissioners. Blasting is not permitted.
- 4 The petitioner/contractor shall furnish all flagmen, lights, barricades, and warning signs meeting all laws and regulations, including those in the "Manual or Uniform Traffic Control Devices" appropriate for the construction project. The petitioner/contractor agrees to keep the road open to traffic unless approved by the Board of County Commissioners. At the conclusion of such work, the right-of-way must be cleaned up and left in a presentable condition.
- 5 In some cases, the petitioner/contractor shall post a performance bond in an amount to be determined by the Board of County Commissioners. Necessity for such bond will be determined by the Board of County Commissioners and the bond will be held in the County Treasurers office until the right-of-way is in a presentable condition.
- 6 When notified to do so by the Board of County Commissioners the petitioner/contractor agrees at their expense to make all changes in the facility on County right-of-way.
- 7 Aerial Facilities-Clearance above the traffic lanes of the road at all aerial pole line crossings shall comply with applicable safety codes and will not be less than 20 feet. All poles, posts, studs, fixtures, down guys, wires, and other appurtenances must be kept in good repair at all times and free from weeds and brush within a 5 foot area of the installation. These facilities, when paralleling the roadway, shall be single pole line construction and located within 3 feet of the fence line, if a fence exists. If no fence exists the right-of-way line shall be located by an Oklahoma Registered Surveyor at the petitioner's expense and a copy provided to the Board prior to construction. All crossings shall be as nearly perpendicular as possible. Facility shall not interfere with the natural flow line of waterways or ditch.
- 8 Underground Facilities- All shall be a minimum of 5 feet below the elevation of the centerline of the road, but not less than 4 feet below the bottom of the ditch. Crossings shall be encased from right-of-way line to right-of-way line and be vented off the right-of-way lines. Concrete caps 4' wide and 6" deep may be required from edge of road to fence line. Identification markers shall be installed at each right-of-way line directly above the facility. The markers must identify the owner's name, address, telephone number, size of facility, and emergency contact number in compliance with the APWA Uniform Color Code for marking. All underground electric cable crossings must be placed in a conduit

and be a minimum of 4 feet below the ditch flow lines. Conduit placed beneath a roadway must be steel, HDPE, heavy duty PVC, or fiberglass if it is designed to withstand roadway loading and is properly protected.

Steel pipelines crossing the right-of-way may be installed without encasement if the carrier pipe material within the right-of-way is superior to the carrier pipe material outside the right-of-way by being of steel at least one grade better and of the same wall thickness, or a minimum of one wall thickness greater and of the same alloy. Pipe must be properly protected from corrosion.

Facilities such as water and sanitary sewer lines crossing the county right-of-way shall be encased. The Board of County Commissioners may approve a line without casing if cast or ductile iron, HDPE or material of equal design is used. Maintenance will be performed by a method that will not disturb the through lanes or interfere with traffic. All conduits shall be sufficient to withstand roadway loadings.

- 9 All section corners and ¼ section corners shall be protected. No lines shall cross within 50 feet of a ¼ section corner or 100 feet of a bridge.
- 10 Owners of all facilities shall be responsible, at their expense, for decommissioning of sites. Roads and right-of-way shall be restored to the original condition or better.
- 11 The granting of this temporary easement does not take into consideration whether or not the adjoining property owner is entitled to compensation for the easement being placed in the county road right-of-way.
- 12 Above ground water line running parallel with road shall be placed within 3 feet of fence line as not to disrupt road maintenance. Any line interfering with road maintenance equipment will be removed.
- 13 **No fees on Public Utilities** by State Law but permit must still be filed and approved.

Schedule of Fees

Road Bored	\$500.00
Cut or Trenched	Up To \$5000.00
Overhead Lines	\$500.00

If a line is placed in county right-of-way without a utility permit, there shall be a fine of \$10,000.00 plus court fees.

Ag Permit

When Bored for all Water or Low Pressure Gas Line	\$25.00
For Overhead Electric Lines	\$50.00

I hereby attest to the accuracy of the information contained on this application. I further certify that, in my professional opinion, the facility line as installed, the drawings, plans and specifications therefore comply in all respects with the requirements of said permit.

Charles Hutchings for Norman Williams 1/6/2017 208.788⁸ 0352
 Petitioner/Contractor Signature Date Phone#

Environmental Planner
Title

Permit Approval

The undersigned Board of County Commissioners do hereby grant the crossing described in the supplication herein above set forth: provided that, the same shall be subject to the terms and conditions of the application incorporated herein by this reference.

Approved/Disapproved on this 16th Day of January, 2017

County Dist # 2

Board of County Commissioners

[Signature]
Chairman

[Signature]
Vice-Chairman

[Signature]
Member

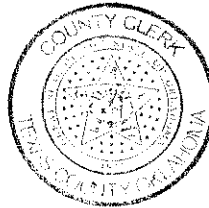

Attest: Wendy Johnson
County Clerk/Deputy

Dated: January 16, 2017

CERTIFICATE OF COMPLIANCE
(Utility Permit # 28-16-17)

PLEASE NOTE: an officer must sign this Certificate of Compliance
of your firm or a Project Director.

I, the undersigned _____, do hereby certify that I am
_____ (title), a person deemed qualified by the Permit Holder to inspect said
installation, and that I have personally inspected a utility pipeline facility and all drawings, plans and
specifications therefore; installed by GridLiance dba South Central MCN (permit holder) at
(give legal description):

See attached project description and associated maps.

I further certify that I have read the provisions of the Facility and Pipeline Utility Permit Submitted by the
above Permit Holder to the Board of County Commissioners for installation of a line at the above location. I
further certify that, in my professional opinion, the facility line as installed, and the drawings, plans and
specifications therefore comply in all respects with the requirements of said Permit.

Signature

Title/Firm/Owner

Address

Telephone

Completion Date/Date of Inspection

SUBMIT TO BOARD OF COUNTY COMMISSIONERS AT TEXAS COUNTY COURTHOUSE, PO BOX
197, GUYMON, OKLAHOMA, 73942, WITHIN 24 HOURS OF COMPLETION OF FACILITY OR
PIPELINE INSTALLATION.

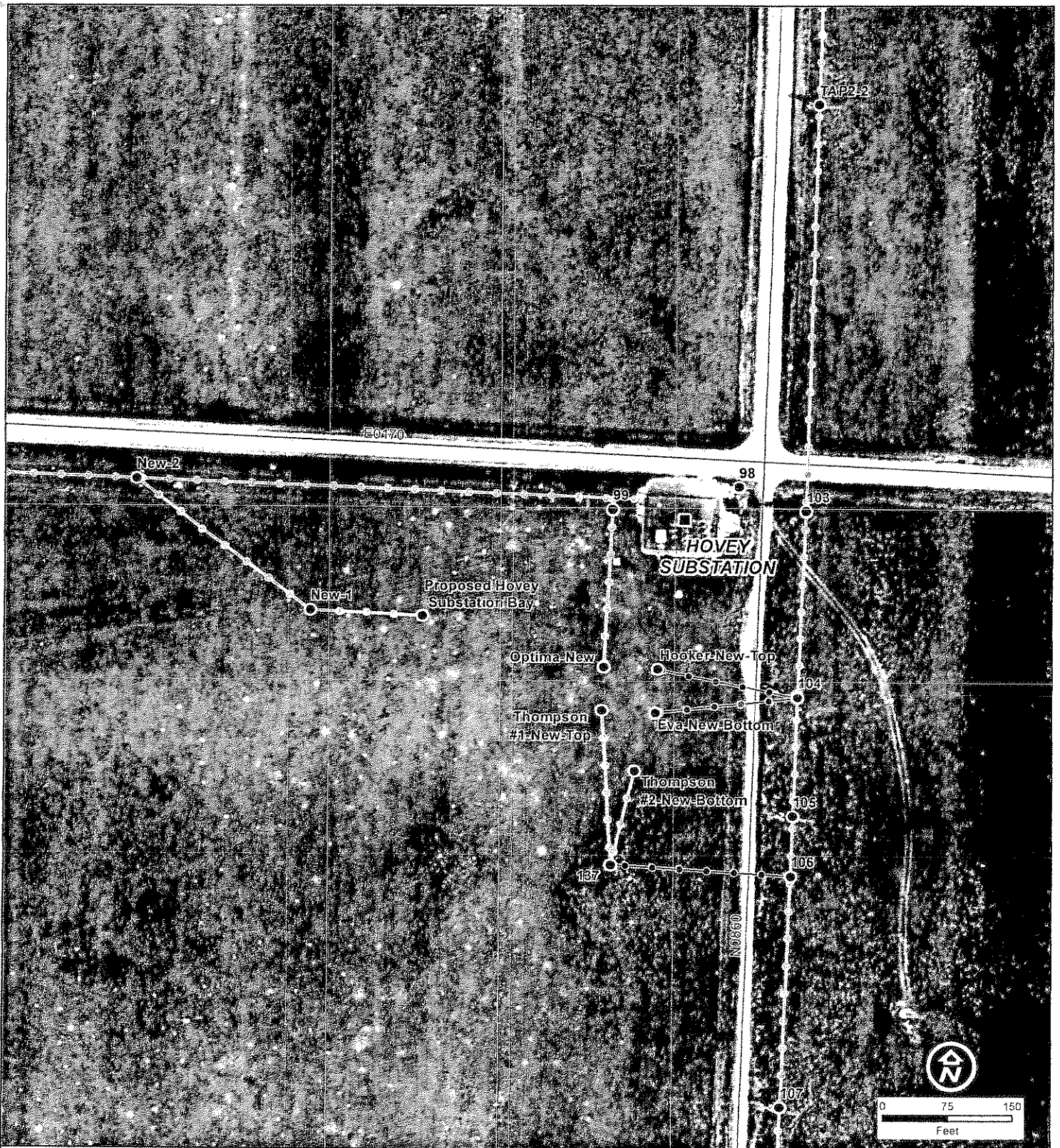

Legend

- Existing Substation
- Existing Transmission Structure
- Proposed Transmission Structure
- County / Local Road
- County Road Crossing
- Proposed Transmission Connections
- Existing 69 kV Transmission Line

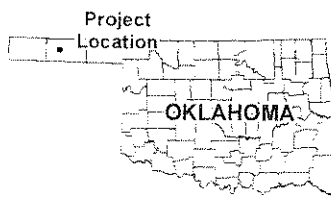

TRI-COUNTY 115 KV TRANSMISSION FACILITY

FIGURE 3

N0860 ROAD - NEW CROSSING

THIS DRAWING WAS PREPARED BY POWER ENGINEERS, INC. FOR A SPECIFIC PROJECT, TAKING INTO CONSIDERATION THE SPECIFIC AND UNIQUE REQUIREMENTS OF THE PROJECT. REUSE OF THIS DRAWING OR ANY INFORMATION CONTAINED IN THIS DRAWING FOR ANY PURPOSE IS PROHIBITED UNLESS WRITTEN PERMISSION FROM BOTH POWER AND POWERS CLIENT IS GRANTED.

A	ISSUED FOR REVIEW		CM	DZ	JT	
REV	REVISIONS	DATE	DRN	DSGN	CKD	APPD

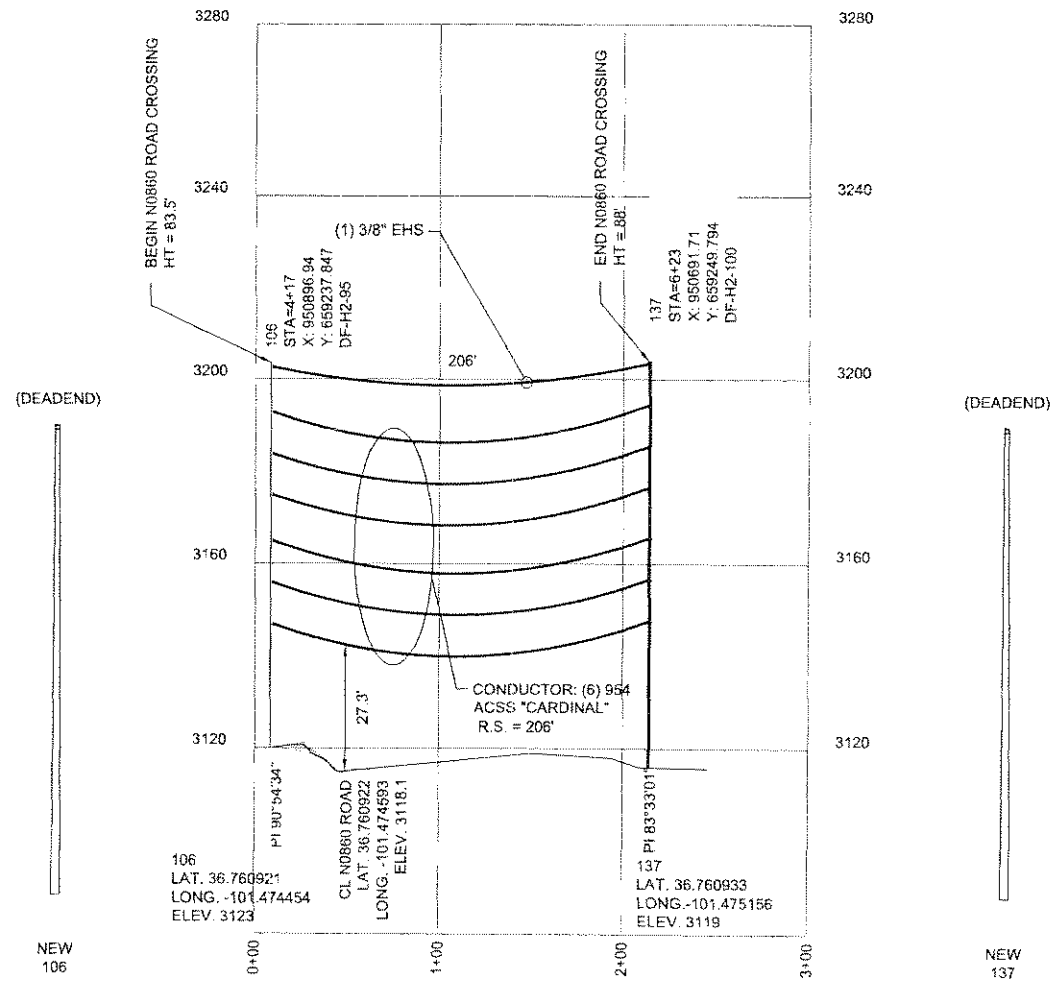
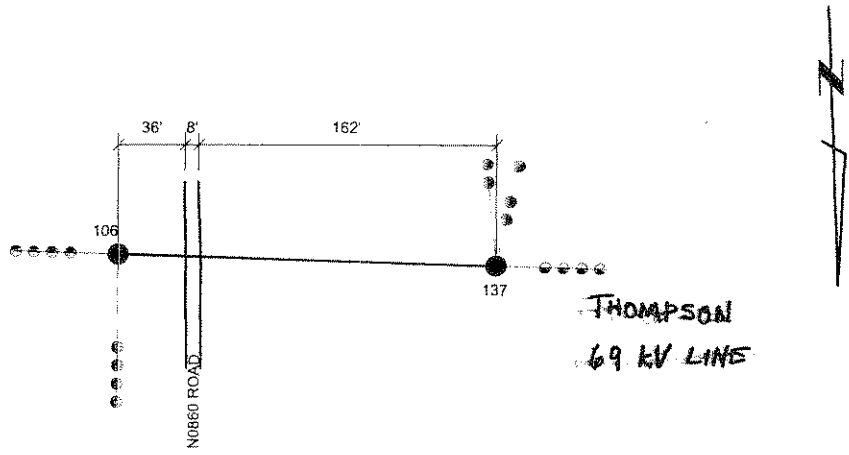

142049.031.001-009.dwg

DSGN	DZ	12/19/16	
DRN	CM	12/19/16	
CKD	JT		
SCALE:	1"=100'		



SOUTH CENTRAL MCN, LLC
HOVEY SUBSTATION
N0860 ROAD CROSSING

JOB NUMBER	142049	REV	A
DRAWING NUMBER	031.009		

REFERENCE DRAWINGS

FOR 8.5x11 DWG ONLY

January 6, 2017

GRIDLIANCE GP, LLC

Tri-County 115 kV Transmission Facility

Environmental Permitting Support

PROJECT NUMBER:
142049

PROJECT CONTACT:
Charles Hutchinson, AICP

EMAIL:
charles.hutchinson@powereng.com

PHONE:
208 788 0352



PREPARED FOR: TEXAS COUNTY, OKLAHOMA
ON BEHALF OF GRIDLIANCE GP, LLC

PREPARED BY: CHARLES HUTCHINSON, AICP
charles.hutchinson@powereng.com
208.788.0352

TABLE OF CONTENTS

1.0 INTRODUCTION..... 1

2.0 PROJECT DESCRIPTION..... 1

3.0 ENVIRONMENTAL PERMITTING SUPPORT..... 2

 3.1 LOCAL GOVERNMENT COORDINATION 2

 3.2 STATE GOVERNMENT COORDINATION 2

 3.3 FEDERAL GOVERNMENT COORDINATION 3

4.0 PROJECT AREA MAPS..... 3

5.0 PLAN AND PROFILE DRAWINGS 3

ACRONYMS AND ABBREVIATIONS

GridLiance	GridLiance GP, LLC, the parent company of South Central MCN
kV	kilovolt
ODOT	Oklahoma Department of Transportation
POWER	POWER Engineers, Inc.
S.H. 3	State Highway 3
U.S. 64	United States Highway 64

1.0 INTRODUCTION

GridLiance GP, LLC (GridLiance) proposes to upgrade its existing 69 kilovolt (kV) electric power transmission system to carry 115 kV in unincorporated Texas County, Oklahoma, northwest of Guymon, Oklahoma (Project). Figure 1 shows the Project's location. GridLiance contracted POWER Engineers, Inc. (POWER) to provide the Project's transmission line design and engineering, and environmental permitting support services.

2.0 PROJECT DESCRIPTION

Implementing the Project will include the following activities and components, and will proceed in the sequence listed below:

1. Install 69 kV and 115 kV equipment and facilities at the proposed Powell Corner Substation, which will be situated on an existing pad site on the Mile 22 Road-U.S. Highway 64 (U.S. 64) / State Highway 3 (S.H. 3) intersection's northwest side in Section 34, Township 4 North, Range 13 East:
 - a. Install a temporary "Shoo-Fly" 115 kV transmission line on the proposed Powell Corner Substation's north side to tap into the existing north-south Dry Trail 115 kV transmission line, follow the proposed substation's west boundary, cross U.S. 64 / S.H. 3, and extend east to connect to the existing north-south Goodwell 115 kV transmission line. During the proposed Powell Corner Substation's construction, this temporary transmission line will maintain electric power reliability along the existing Dry Trail-Goodwell transmission system.
 - b. Install the proposed Thrash 69 kV transmission line's equipment and facilities in the proposed Powell Corner Substation's southwest corner. Installing this line's equipment and facilities will require one (1) new overhead span crossing U.S. 64 / S.H. 3.
 - c. Connect the re-conducted Hovey 115 kV transmission line on U.S. 64's / S.H. 3's south side to the proposed Powell Corner Substation. Connecting the re-conducted line to the proposed substation will require one (1) new overhead span crossing U.S. 64 / S.H. 3.
 - d. Reconfigure the existing north-south Thrall 69 kV transmission line on Mile 22 Road's east side to connect to the proposed Powell Corner Substation. GridLiance proposes to install a wood pole 23.8 feet east of Mile 22 Road's centerline and a guy anchor 23.1 feet east of Mile 22 Road's centerline. **Connecting the existing line to the proposed substation will require one (1) new overhead span crossing Mile 22 Road. Figure 2 shows the proposed crossing, associated transmission structures, and the structures' distances from Mile 22 Road's centerline.**
2. Between the proposed Powell Corner Substation on the west and the proposed Hovey Substation on the east, re-conductor the existing east-west 69 kV transmission line to carry 115 kV. The majority of the re-conductor work will occur along the south side of U.S. 64 / S.H. 3. The re-conducted line will extend approximately nine (9) miles and will require installing 12 new single-circuit 115 kV H-frame and three-pole wood structures to replace existing structures in the same locations. All other existing structures will remain in place with only the overhead electric conductor being replaced, that is, re-conducted.

The existing east-west 69 kV line crosses the following Texas County roads: Road Q, N0810 Road, Road 25, Mile 23 Road, and Mile 22 Road. The re-conducted line will also cross these roads. Of the 12 new structures mentioned above, one (1) new structure will replace the existing structure on Road 25's east side, and one (1) new structure will replace the existing structure on Mile 22 Road's east side.

3. Replace the existing Hovey Substation with a proposed substation and 69 kV equipment and facilities in the same general area on the Road Q-N0860 Road intersection's southwest side in Section 6, Township 3 North, Range 15 East:
 - a. Reconfigure the existing north-south Optima 69 kV transmission line to connect to the proposed Hovey Substation. Reconfiguring this line will include adding one (1) new guy anchor wire 29.4 feet south of Road Q's centerline, just west of the existing substation and along the existing Hovey 69 kV line's corridor. Reconfiguring the Optima 69 kV line will not require new spans crossing Texas County roads.
 - b. Connect the proposed Hovey Substation to the existing north-south Hooker and Eva 69 kV transmission lines. **Connecting the proposed substation to these existing lines will require two (2) new overhead spans crossing N0860 Road. Figure 3 shows the proposed crossings and associated transmission structures.**
 - c. Connect the proposed Thompson #1 69 kV transmission line and Thompson #2 69 kV transmission line to the existing north-south Eva 69 kV and Hooker 69 kV transmission lines. **Connecting the proposed Thompson lines to the existing lines will require one (1) new overhead span crossing N0860 Road. Figure 3 shows the proposed crossing and associated transmission structures.**

Project construction activities are anticipated to begin in Winter 2017 and end in Summer 2017.

3.0 ENVIRONMENTAL PERMITTING SUPPORT

POWER is providing environmental permitting support for the transmission line activities noted above. More specifically, POWER's environmental staff are coordinating Project information with local, state, and federal government agency staff with jurisdiction in the Project area to identify and obtain the regulatory permits and approvals that are required prior to Project construction activities.

3.1 Local Government Coordination

POWER coordinated with the Texas County Clerk's Office to identify and understand county permitting requirements for the new spans noted above that would cross county road rights-of-way. POWER received the county's Utility Permit application and is providing the required information for the transmission line facilities.

3.2 State Government Coordination

POWER coordinated with the Oklahoma Department of Transportation's Division 6 staff to identify and understand permitting requirements for the new spans noted above that would cross U.S. 64 / S.H. 3. In locations where the existing east-west 69 kV line spans this road and will only be re-conducted with no new transmission poles installed, Oklahoma DOT staff consider the Project to be a maintenance activity and do not require a utility permit. Oklahoma DOT staff only require a utility permit for locations where the re-conducted line and the Shoo-Fly line span this road in new

locations. On December 6, 2016, POWER submitted the ODOT Form M4 for a Utility Permit to ODOT's office in Buffalo, Oklahoma. ODOT approved the application and is issuing the permit.

3.3 Federal Government Coordination

POWER coordinated with the Oklahoma Ecological Services Field Office to identify and understand permitting requirements for Project activities that might affect threatened and endangered species in and around the Project area. On December 9, 2016, POWER submitted the required information to the Oklahoma Ecological Services Field Office. POWER is awaiting this agency's review of the information.

4.0 PROJECT AREA MAPS

The attached Project area maps include the following:

- Figure 1 – Project Location Map
- Figure 2 – Mile 22 Road – New Crossing
- Figure 3 – N0860 Road – New Crossing







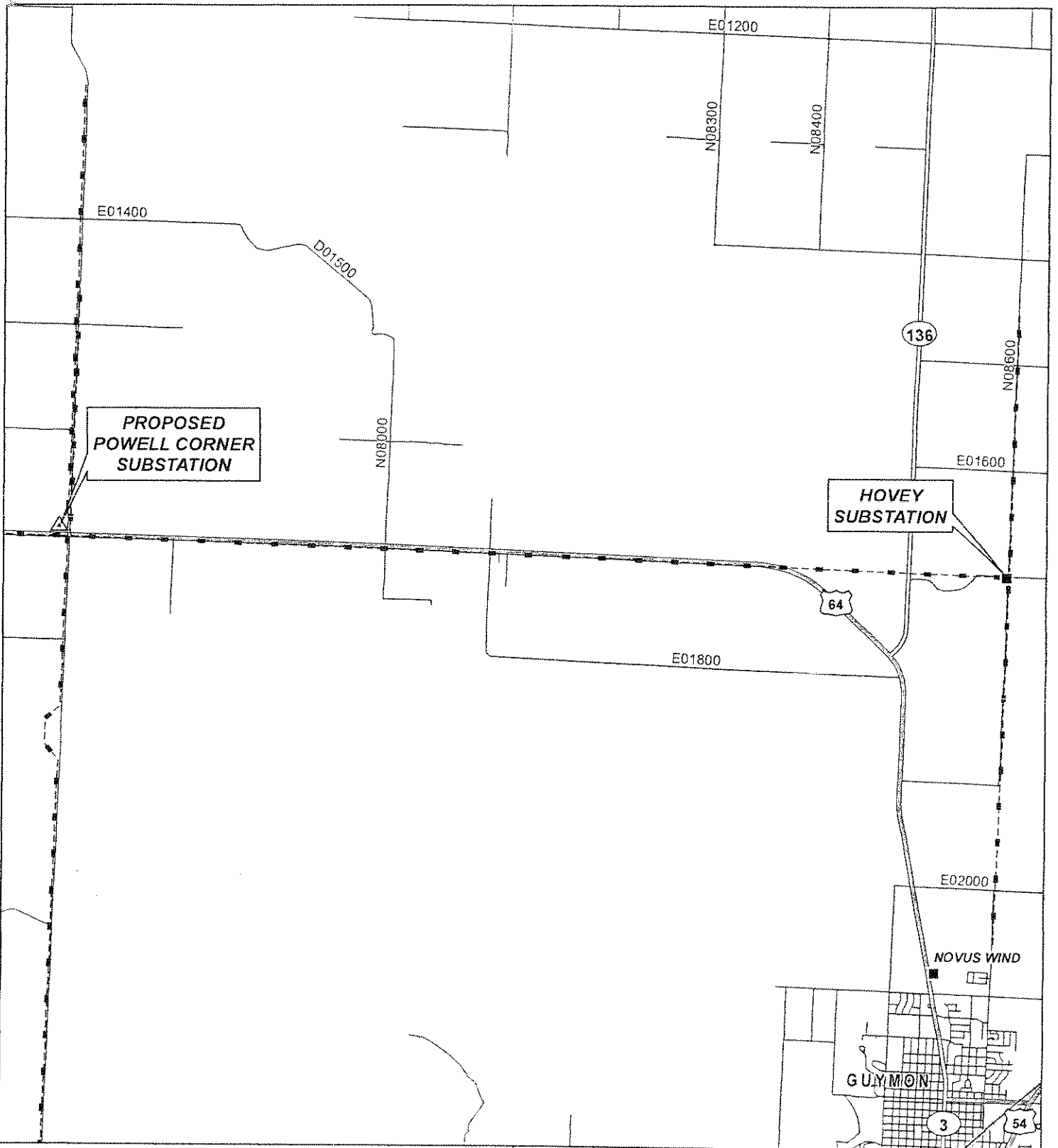

5.0 PLAN AND PROFILE DRAWINGS

The attached plan and profile drawings include the following:

- Thrall 69 kV Transmission Line – new span crossing Mile 22 Road
- Hooker 69 kV Transmission Line – new span crossing N0860 Road
- Eva 69 kV Transmission Line – new span crossing N0860 Road
- Thompson 69 kV Transmission Line – new span crossing N0860 Road



Legend

-  Proposed Substation
-  Existing Substation
-  Existing Transmission Line
-  River / Stream
-  Railroad
-  US Highway
-  State Highway
-  County / Local Road

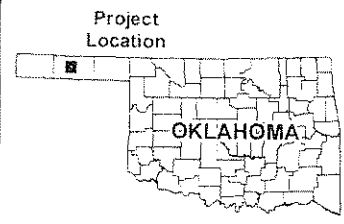

**TRI-COUNTY 115 KV
TRANSMISSION FACILITY**

FIGURE 1

**PROJECT LOCATION
MAP**



POWER ENGINEERS, INC.
3340 GLENBROOK DRIVE
PO BOX 1066
HAILEY, ID 83333 USA

PHONE 208-788-3456
FAX 208-788-2082

January 9, 2017

Texas County Board of County Commissioners
P. O. Box 197
319 North Main Street
Guymon, OK 73942

Subject: Tri-County 115 kV Transmission Facility – Public Service/Pipeline Crossing Line
Installation

Dear Commissioner Bryan:

Enclosed please find four (4) Public Service/Pipeline Crossing Line Installation permit applications for GridLiance GP, LLC's (GridLiance) proposed Tri-County 115 kilovolt (kV) Transmission Facility (Project) in unincorporated Texas County, Oklahoma. POWER Engineers, Inc. (POWER) has prepared one (1) permit application for each of the Project's new transmission line spans crossing the following Texas County road rights-of-way:

1. Thrall 69 kV Transmission Line – new span crossing Mile 22 Road
2. Hooker 69 kV Transmission Line – new span crossing N0860 Road
3. Eva 69 kV Transmission Line – new span crossing N0860 Road
4. Thompson 69 kV Transmission Line – new span crossing N0860 Road

Enclosed please also find the *Environmental Permitting Support* document, which includes the Project Description, Project Area Maps, and Plan and Profile Drawings for each of the transmission line crossings listed above.

Should you have questions and/or comments about the Project or require additional information, please contact me at 208.788.0352 or via email at charles.hutchinson@powereng.com.

Sincerely,

Charles Hutchinson, AICP
Environmental Planner

c: Holger Peller (POWER)
Beverly Thompson (POWER)