

RESOLUTION FOR APPROVAL OF UTILITY PERMITS
(RESOLUTION # 21-16-17)

Dist. 2

WHEREAS, the Statutes of the State of Oklahoma [OKLA. STAT. Tit. 18, § 437.2 and 438.4 (1991) and OKLA STAT. Tit. 69, § 1401 (1991)] provide that rural electric cooperatives, telephone cooperative corporations and public utilities shall have the right-of-way and all easements pertaining thereto for the purpose of erecting poles and posts, attaching equipment wires and fixtures thereto and laying lines, pipes and conduits under the surface thereof.

WHEREAS, HIGH PLAINS BIOENERGY has requested this Board's approval of placement of utility lines (poles, pipelines, telecommunication lines or power lines) within the County right-of-way at the following location, to-wit:

Section 21 TOWNSHIP 5N RANGE 15E
Section 22 TOWNSHIP 5N RANGE 15E

WHEREAS, petitioner must meet all requirements of the permit.

THEREFORE, BE IT RESOLVED, the Board of County Commissioners of Texas County, Oklahoma, does hereby consent to the placement of a distribution line according to the requirements as set forth in the completed Permit Application attached. With the following special instruction to be included:

All requirements of the permit shall be met and it shall be trenched.

PERMIT # 21-16-17 Granted this 5th day of December 20 16.

BOARD OF COUNTY COMMISSIONERS

[Signature]
Chairman

[Signature]
Member

[Signature]
Member



ATTEST:

[Signature]
Texas County Clerk

D2

STATE OF OKLAHOMA
TEXAS COUNTY
PUBLIC SERVICE/PIPELINE CROSSING
LINE INSTALLATION
(Revised May 14, 2015)

We, the undersigned, hereby petition the Texas County Board of County Commissioners to grant a permit for a public service, pipeline crossing, or line installation as described below and in accordance with the provisions as listed.

PUBLIC SERVICE/PIPELINE OWNER	CONSTRUCTION COMPANY
Name <u>TCEC/HIGH PLAINS BIOENERGY</u>	Name <u>HYDRO-PRO</u>
Contact <u>RANDY STAVIG</u>	Contact <u>ROGER VALLIQUETTE</u>
Address <u>3291 DESERT Rd.</u>	Address <u>213 CIRCLE DR</u>
City <u>GUYMON</u> State <u>OK</u> Zip <u>75942</u>	City <u>GUYMON</u> State <u>OK</u> Zip <u>75942</u>
Phone <u>580-468-3790</u> <u>580-651-1032</u>	Phone <u>580-651-5933</u>

TYPE OF INSTALLATION

Electric Gas Oil Water Telephone Sewer Other

The installation will be made in the following manner:
 Boring Pushing Overhead Crossing Other TRENCHING

A permit to erect, construct and maintain (new) electric power line along, upon and across the hereinafter said county highway or road for the purpose of transporting, selling, and using electricity. A plat shall be attached clearly illustrating work to be performed and further described as follows:

LOCATION:

Start point in the _____ Qtr. of the _____ Qtr. of Section 21 Township 3N Range 15E
 Crossing or parallel to county road number 880
 Ending point in the _____ Qtr. of the _____ Qtr. of Section 22 Township 3N Range 15E

PIPELINES	ELECTRIC	COMMUNICATIONS
Size _____	Voltage <u>12,470</u>	Wires/Pairs/Strands _____
Alloy/Material _____	Conductor Size <u>4/0 UNDERGROUND</u>	Gauge _____
Contents _____	Type of Structure <u>N/A</u>	Cable Type _____
Mfg. Test Pressure _____	Ruling Span <u>N/A</u>	
Working Pressure _____		
Max. Operating Pressure _____		

CASING

Size 10"
 Alloy/Material AVC
 Wall Thickness SCHEDULE 80

WEST Side 22
 EAST Side 21

If granted, this permit is subject to the following conditions, requirements, and covenants, to wit:

- 1 Applications for road crossing must be submitted to the County Clerk no later than 5 days before a meeting of the Board of County Commissioners with a check for the amount of permit made payable to the TEXAS County Commissioners. The petitioner/contractor shall contact The County Commissioners Office at the completion of crossing for an onsite inspection.
To: Texas County Commissioners
PO Box 197 319 N Main. St.
Guymon, OK. 73942
- 2 The applicant must agree to hold Texas County harmless for any damage or injury to persons or property caused by or resulting from the construction, maintenance, operation, or repair of the facilities on, under, or over the County right-of-way. The petitioner/contractor will be responsible for any damage resulting from deviation of the plat.
- 3 All crossings shall be bored on blacktop/asphalt roads. Cutting may be permitted on caliche/dirt roads, ditches, or other surfaces with approval from the Board of County Commissioners. Blasting is not permitted.
- 4 The petitioner/contractor shall furnish all flagmen, lights, barricades, and warning signs meeting all laws and regulations, including those in the "Manual or Uniform Traffic Control Devices" appropriate for the construction project. The petitioner/contractor agrees to keep the road open to traffic unless approved by the Board of County Commissioners. At the conclusion of such work, the right-of-way must be cleaned up and left in a presentable condition.
- 5 In some cases, the petitioner/contractor shall post a performance bond in an amount to be determined by the Board of County Commissioners. Necessity for such bond will be determined by the Board of County Commissioners and the bond will be held in the County Treasurers office until the right-of-way is in a presentable condition.
- 6 When notified to do so by the Board of County Commissioners the petitioner/contractor agrees at their expense to make all changes in the facility on County right-of-way.
- 7 Aerial Facilities-Clearance above the traffic lanes of the road at all aerial pole line crossings shall comply with applicable safety codes and will not be less than 20 feet. All poles, posts, studs, fixtures, down guys, wires, and other appurtenances must be kept in good repair at all times and free from weeds and brush within a 5 foot area of the installation. These facilities, when paralleling the roadway, shall be single pole line construction and located within 3 feet of the fence line, if a fence exists. If no fence exists the right-of-way line shall be located by an Oklahoma Registered Surveyor at the petitioner's expense and a copy provided to the Board prior to construction. All crossings shall be as nearly perpendicular as possible. Facility shall not interfere with the natural flow line of waterways or ditch.
- 8 Underground Facilities- All shall be a minimum of 5 feet below the elevation of the centerline of the road, but not less than 4 feet below the bottom of the ditch. Crossings shall be encased from right-of-way line to right-of-way line and be vented off the right-of-way lines. Concrete caps 4' wide and 6" deep may be required from edge of road to fence line. Identification markers shall be installed at each right-of-way line directly above the facility. The markers must identify the owner's name, address, telephone number, size of facility, and emergency contact number in compliance with the APWA Uniform Color Code for marking. All underground electric cable crossings must be placed in a conduit

and be a minimum of 4 feet below the ditch flow lines. Conduit placed beneath a roadway must be steel, HDPE, heavy duty PVC, or fiberglass if it is designed to withstand roadway loading and is properly protected.

Steel pipelines crossing the right-of-way may be installed without encasement if the carrier pipe material within the right-of-way is superior to the carrier pipe material outside the right-of-way by being of steel at least one grade better and of the same wall thickness, or a minimum of one wall thickness greater and of the same alloy. Pipe must be properly protected from corrosion.

Facilities such as water and sanitary sewer lines crossing the county right-of-way shall be encased. The Board of County Commissioners may approve a line without casing if cast or ductile iron, HDPE or material of equal design is used. Maintenance will be performed by a method that will not disturb the through lanes or interfere with traffic. All conduits shall be sufficient to withstand roadway loadings.

- 9 All section corners and ¼ section corners shall be protected. No lines shall cross within 50 feet of a ¼ section corner or 100 feet of a bridge.
- 10 Owners of all facilities shall be responsible, at their expense, for decommissioning of sites. Roads and right-of-way shall be restored to the original condition or better.
- 11 The granting of this temporary easement does not take into consideration whether or not the adjoining property owner is entitled to compensation for the easement being placed in the county road right-of-way.
- 12 Above ground water line running parallel with road shall be placed within 3 feet of fence line as not to disrupt road maintenance. Any line interfering with road maintenance equipment will be removed.
- 13 **No fees on Public Utilities** by State Law but permit must still be filed and approved.

Schedule of Fees

Road Bored	\$500.00
Cut or Trenched	Up To \$5000.00
Overhead Lines	\$500.00

If a line is placed in county right-of-way without a utility permit, there shall be a fine of \$10,000.00 plus court fees.

Ag Permit

When Bored for all Water or Low Pressure Gas Line	\$25.00
For Overhead Electric Lines	\$50.00

I hereby attest to the accuracy of the information contained on this application. I further certify that, in my professional opinion, the facility line as installed, the drawings, plans and specifications therefore comply in all respects with the requirements of said permit.

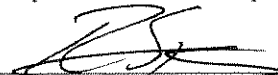
	11-29-16	590-651-1032
Petitioner/Contractor Signature	Date	Phone#

CNA BUSINESS MANAGER
Title

Permit Approval

The undersigned Board of County Commissioners do hereby grant the crossing described in the supplication herein above set forth; provided that, the same shall be subject to the terms and conditions of the application incorporated herein by this reference.

Approved/Disapproved on this 5th Day of December, 20 16
County Dist # 2

Board of County Commissioners

[Signature]
Chairman

[Signature]
Vice-Chairman

[Signature]
Member

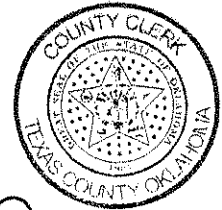

Attest: Wendy Johnson
County Clerk Deputy

Dated: December 5, 20 16

CERTIFICATE OF COMPLIANCE
(Utility Permit # 21-16-17)

PLEASE NOTE: an officer must sign this Certificate of Compliance
of your firm or a Project Director.

I, the undersigned RANDY STAVIG, do hereby certify that I am
PROJECT MANAGER (title), a person deemed qualified by the Permit Holder to inspect said
installation, and that I have personally inspected a utility pipeline facility and all drawings, plans and
specifications therefore; installed by NAB & HYDRO-PRO (permit holder) at
(give legal description):
Section 21 TOWNSHIP SN RANGEISE
Section 22 TOWNSHIP SN RANGEISE

I further certify that I have read the provisions of the Facility and Pipeline Utility Permit Submitted by the
above Permit Holder to the Board of County Commissioners for installation of a line at the above location. I
further certify that, in my professional opinion, the facility line as installed, and the drawings, plans and
specifications therefore comply in all respects with the requirements of said Permit.

Signature

PROJECT MANAGER - HIGH PLAINS BIOENERGY
Title/Firm/Owner

5291 DESSERT RD.
Address

580-468-5790
Telephone

Completion Date/Date of Inspection

SUBMIT TO BOARD OF COUNTY COMMISSIONERS AT TEXAS COUNTY COURTHOUSE, PO BOX
197, GUYMON, OKLAHOMA, 73942, WITHIN 24 HOURS OF COMPLETION OF FACILITY OR
PIPELINE INSTALLATION.

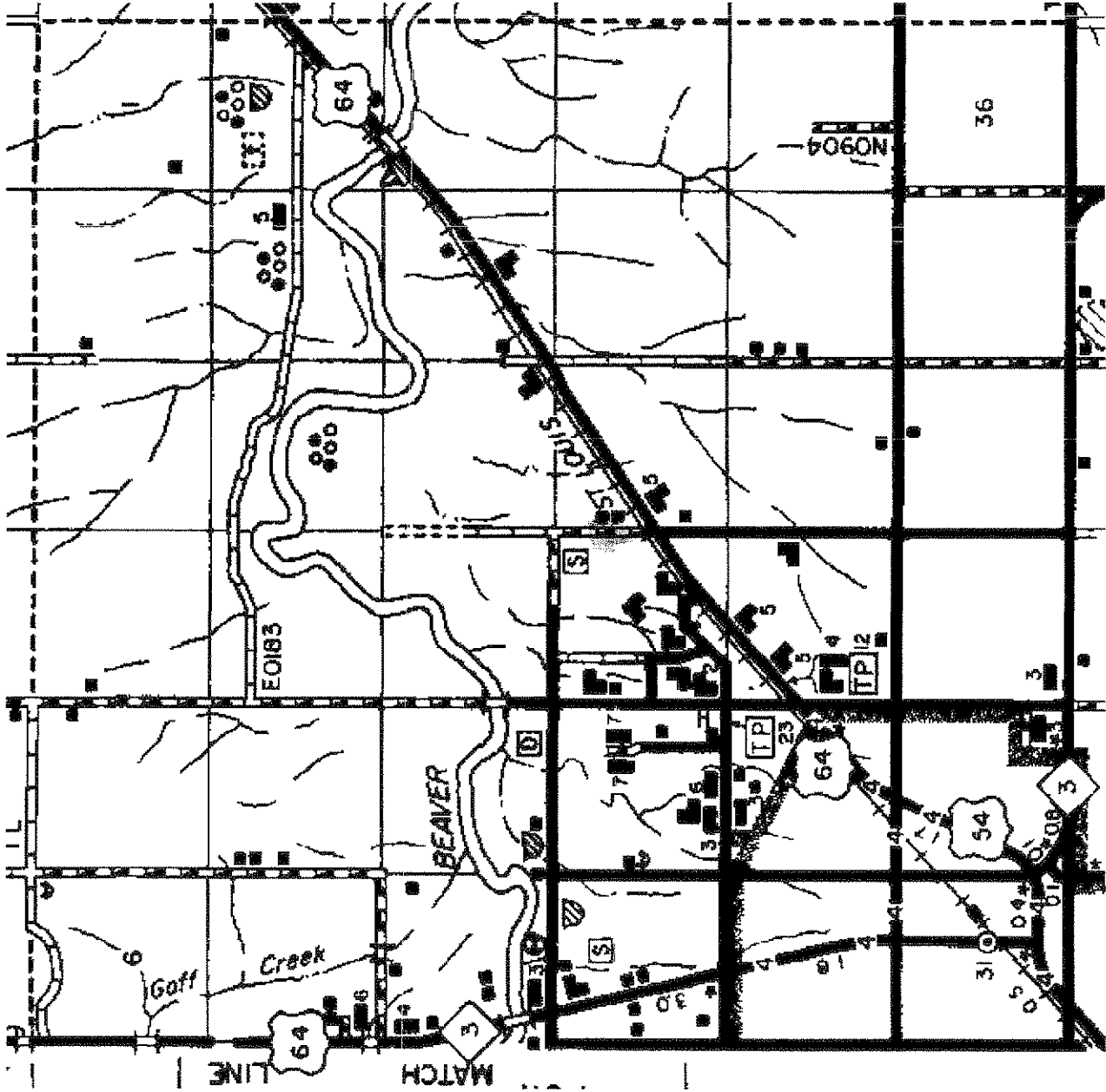

HIG PLAINS REENERGY IS WANTING
 TO TRENCH GOLF ROAD 880 TO LAY A
 NEW UNDERGROUND POWER LINE THAT
 WILL FEED OUR NEW BOGAS SREA
 HPB WILL BE RESPONSIBLE FOR
 CUTTING THE TRENCH AND REPAIRING
 IT WHEN COMPLETE.

REQUESTED TRENCH



**HIGH PLAINS
BIOENERGY**
A subsidiary of Unifield Foods
3971 DESERT ROAD
GUYMON, OKLAHOMA 7342
TEL: 505.466.3790

CARBOTECH BUP SITE SCHEMATIC PLAN
HIGH PLAINS BIOENERGY
3291 DESERT ROAD
GUYMON, TEXAS COUNTY, OKLAHOMA
VACUUM EXCAVATION / SPOT

PROJECT: CARBOTECH BUP
SHEET DESC: VACUUM EXCAVATION
SHEET: 06

